

# FH3204G

## N-Channel Enhancement Mode Power MOSFET

### Description

The FH3204G uses advanced Shielded Gate trench technology and design to provide excellent  $R_{DS(ON)}$  with low gate charge. It can be used in a wide variety of applications.

### Application

- Motor drivers
- Power switching application
- DC/DC Converters In Computing
- Isolated DC/DC Converters In Telecom and Industrial

### General Features

$V_{DSS}$	$I_D$	$R_{DS(ON)}$ ( MAX )
40V	120A	1.6m $\Omega$ @ $V_{GS}=10V$

- High density cell design for ultra low  $R_{ds(on)}$
- Fully characterized avalanche voltage and current
- Good stability and uniformity with high  $E_{AS}$
- Excellent package for good heat dissipation

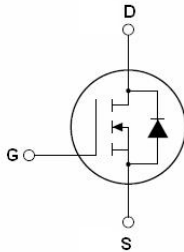

Schematic diagram



Marking and pin Assignment

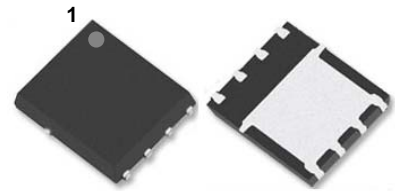

PDFN5X6-8L top and bottom view

## Limiting Values

Symbol	Parameter	Conditions	Min	Max	Unit
$V_{DS}$	Drain-Source Voltage	$T_C = 25\text{ }^\circ\text{C}$	-	40	V
$V_{GS}$	Gate-Source Voltage	$T_C = 25\text{ }^\circ\text{C}$	-	$\pm 20$	V
$I_D^*$	Drain Current	$T_C = 25\text{ }^\circ\text{C}, V_{GS} = 10\text{ V}$	-	120	A
$I_{DM}^{***}$	Pulsed Source Current	$T_C = 25\text{ }^\circ\text{C}, V_{GS} = 10\text{ V}$	-	320	A
$P_{tot}^*$	Total Power Dissipation	$T_C = 25\text{ }^\circ\text{C}$	-	35	W
$T_{stg}$	Storage Temperature		55	150	$^\circ\text{C}$
$T_J$	Junction Temperature		-	150	$^\circ\text{C}$
$I_S$	Diode Forward Current	$T_C = 25\text{ }^\circ\text{C}$	-	120	A
$R_{\theta JA}^*$	Thermal Resistance- Junction to Ambient		-	62.5	$^\circ\text{C} / \text{W}$
$R_{\theta JC}^*$	Thermal Resistance- Junction to Case		-	3.5	

Notes :

- \* Surface Mounted on 1 in<sup>2</sup> pad area,  $t \leq 10\text{ sec}$
- \*\* Pulse width  $\leq 10\text{ }\mu\text{s}$ , duty cycle  $\leq 1\%$
- \*\*\* limited by bonding wire

## Electrical Characteristics (T<sub>A</sub> = 25 °C Unless Otherwise Noted)

Symbol	Parameter	Conditions	Min	Typ	Max	Unit
<b>Static Characteristics</b>						
B <sub>V</sub> DSS	Drain-Source Breakdown Voltage	V <sub>GS</sub> = 0 V, I <sub>D</sub> = 250 μA	40	-	-	V
V <sub>GS(th)</sub>	Gate Threshold Voltage	V <sub>DS</sub> = V <sub>GS</sub> , I <sub>DS</sub> = 250 μA	1.5	2.0	2.5	V
I <sub>DSS</sub>	Zero Gate Voltage Source Current	V <sub>DS</sub> = 32 V, V <sub>GS</sub> = 0 V	-	-	1	μA
		T <sub>J</sub> = 85 °C	-	-	30	μA
I <sub>GSS</sub>	Gate Leakage Current	V <sub>GS</sub> = ± 20 V, V <sub>DS</sub> = 0 V	-	-	± 100	nA
R <sub>DS(ON)</sub> <sup>a</sup>	Drain-Source On-State Resistance	V <sub>GS</sub> = 10 V, I <sub>D</sub> = 20 A	-	1.2	1.6	mΩ
		V <sub>GS</sub> = 4.5 V, I <sub>D</sub> = 10 A	-	1.9	2.5	
<b>Diode Characteristics</b>						
V <sub>SD</sub> <sup>a</sup>	Diode Forward Voltage	I <sub>SD</sub> = 20 A, V <sub>GS</sub> = 0 V	-	-	1.3	V
t <sub>rr</sub>	Reverse Recovery Time	I <sub>SD</sub> = 20 A, dI <sub>SD</sub> /dt = 100 A/μs	-	68	-	ns
Q <sub>rr</sub>	Reverse Recovery Charge		-	92	-	nC
<b>Dynamic Characteristics<sup>b</sup></b>						
C <sub>iss</sub>	Input Capacitance	V <sub>GS</sub> = 0 V, V <sub>DS</sub> = 20 V Frequency = 1 MHz	-	4925	-	pF
C <sub>oss</sub>	Output Capacitance		-	1655	-	
C <sub>rss</sub>	Reverse Transfer Capacitance		-	122	-	
t <sub>d(on)</sub>	Turn-on Delay Time	V <sub>DS</sub> = 20 V, V <sub>GEN</sub> = 10 V, R <sub>G</sub> = 4.5 Ω, R <sub>L</sub> = 1 Ω, I <sub>DS</sub> = 20 A	-	16	-	ns
t <sub>r</sub>	Turn-on Rise Time		-	48	-	
t <sub>d(off)</sub>	Turn-off Delay Time		-	75	-	
t <sub>f</sub>	Turn-off Fall Time		-	42	-	
<b>Gate Charge Characteristics<sup>b</sup></b>						
Q <sub>g</sub>	Total Gate Charge	V <sub>DS</sub> = 20 V, V <sub>GS</sub> = 10 V, I <sub>DS</sub> = 20 A	-	81	-	nC
Q <sub>gs</sub>	Gate-Source Charge		-	18	-	
Q <sub>gd</sub>	Gate-Drain Charge		-	15	-	

Notes :

a : Pulse test ; pulse width ≤ 300 μs, duty cycle ≤ 2 %

b : Guaranteed by design, not subject to production testing

NHCX defines " Green " as lead-free ( RoHS compliant ) and halogen free ( Br or Cl does not exceed 900 ppm by weight in homogeneous material and total of Br and Cl does not exceed 1500 ppm by weight; Follow IEC 61249-2-21 and IPC / JEDEC J-STD-020C )

Typical Characteristics (Cont.)

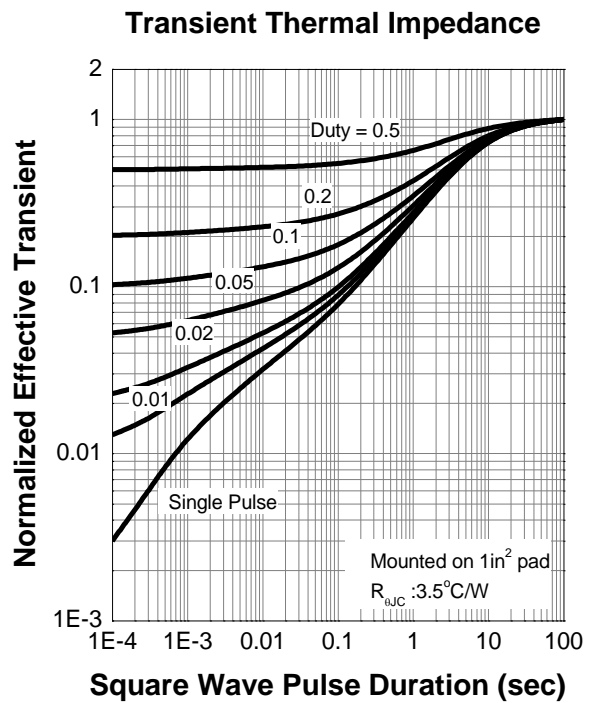
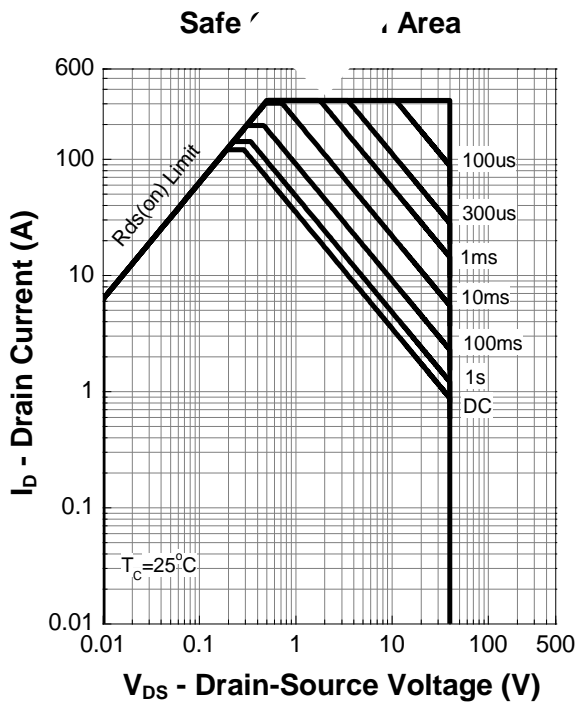
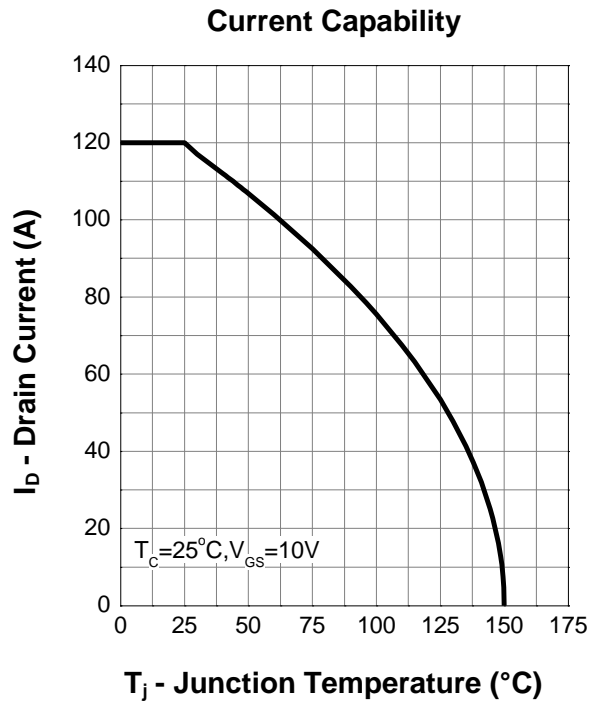
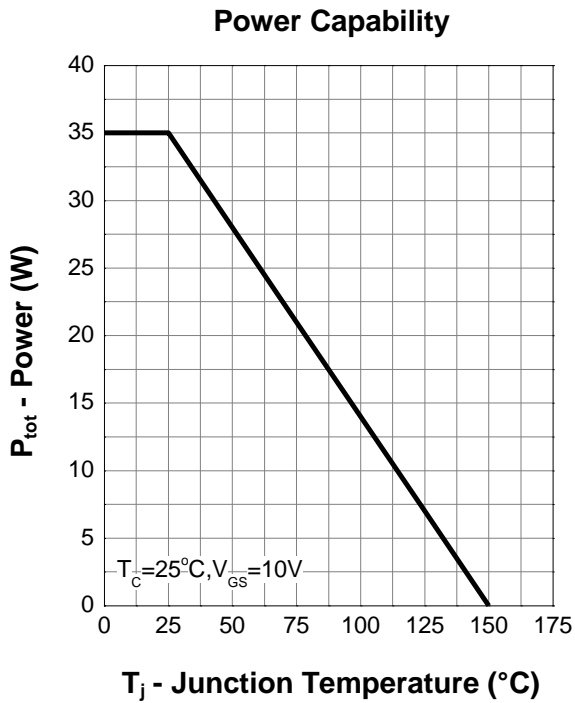

Typical Characteristics ( Cont.)

Output Characteristics

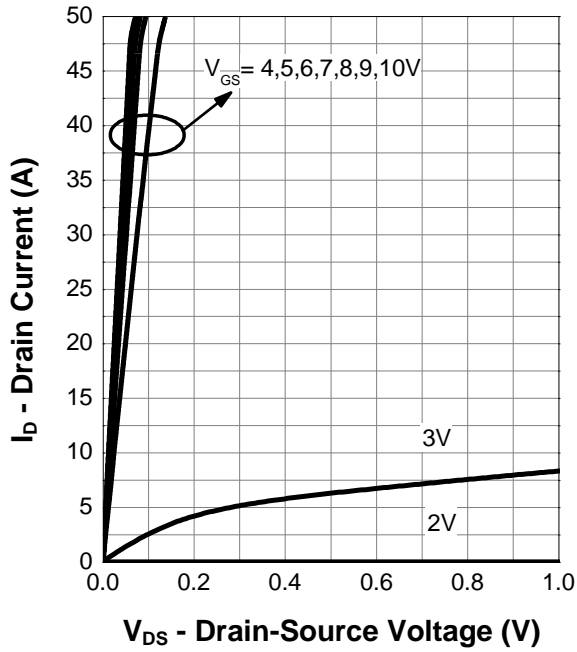

On Resistance

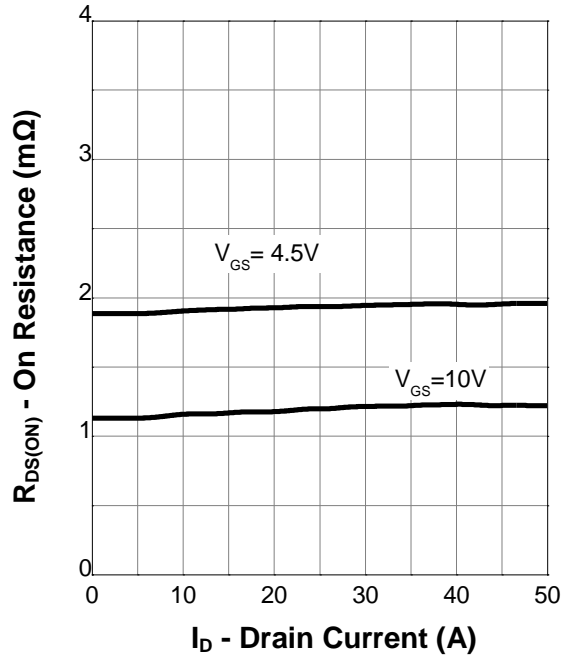

Transfer Characteristics

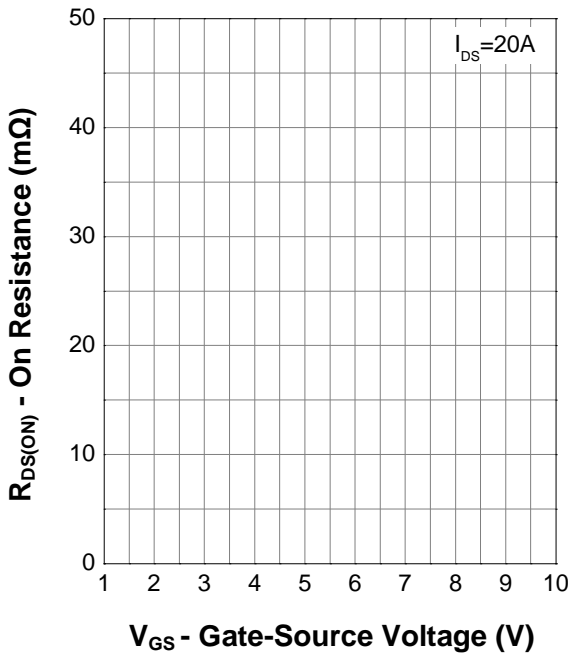

Normalized Threshold Voltage

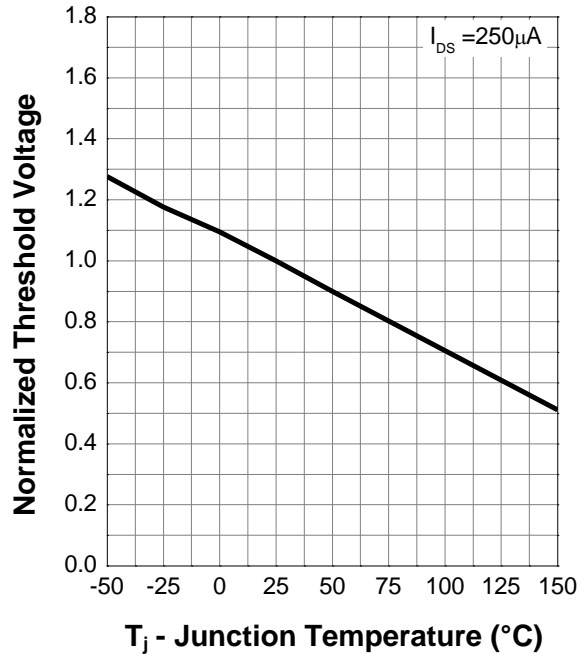

Typical Characteristics ( Cont.)

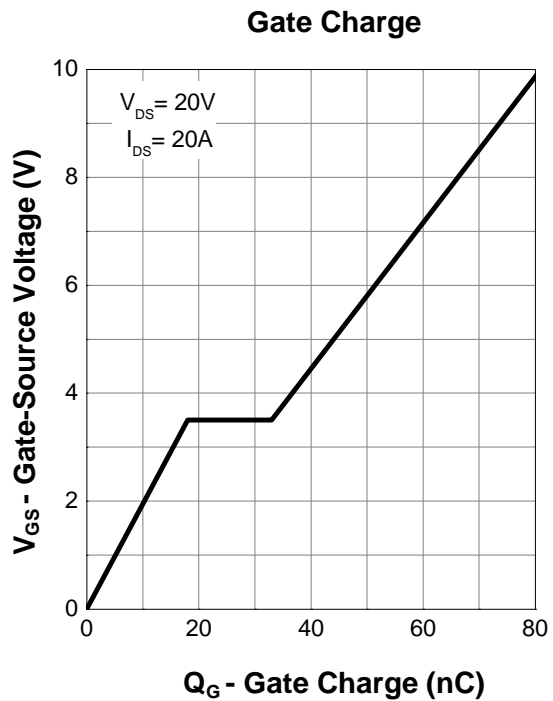
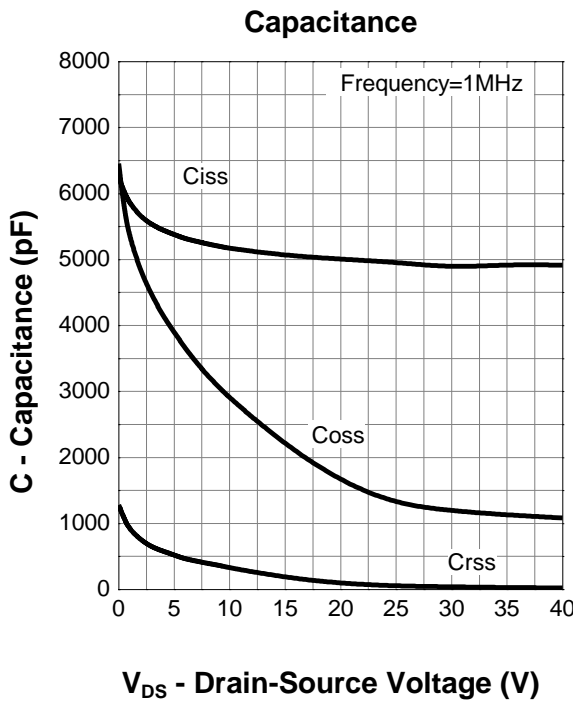
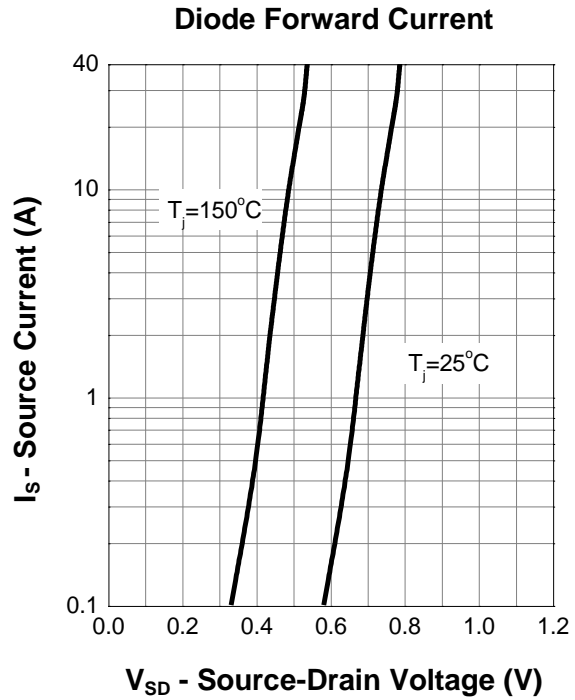
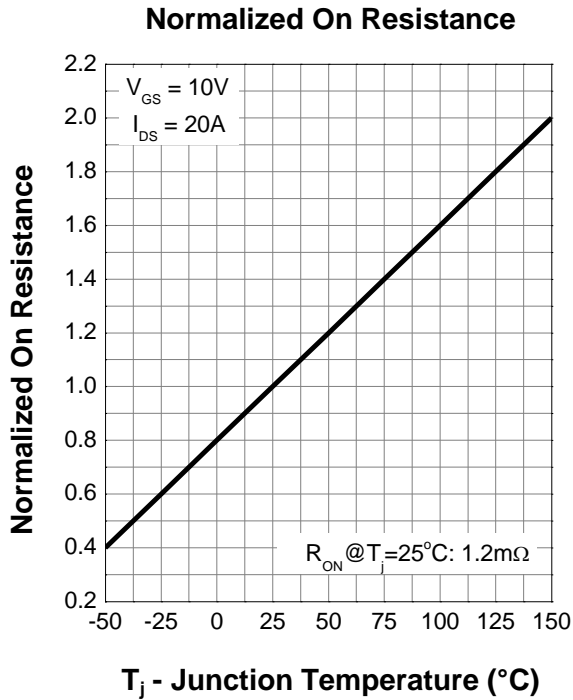

## Package Dimensions : PDFN5x6-8L

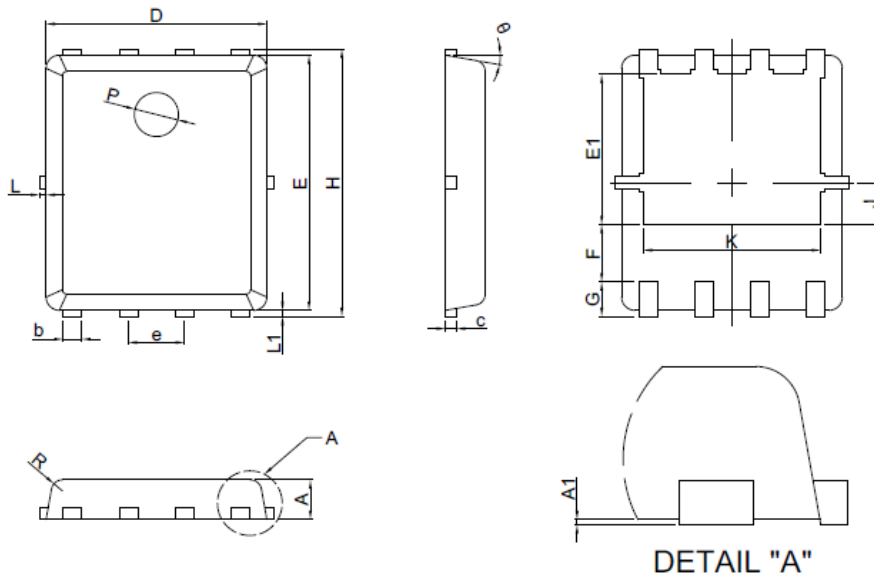

Symbol	Dimensions In Millimeters	
	MIN.	MAX.
A	0.80	1.00
A1	0.00	0.05
b	0.35	0.49
c	0.254REF	
D	4.90	5.10
F	1.40REF	
E	5.70	5.90
e	1.27BSC	
H	5.95	6.20
L1	0.10	0.18
G	0.60REF	
K	4.00REF	
L	-	0.15
J	0.95BSC	
P	1.00REF	
E1	3.40REF	
θ	6°	14°
R	0.25REF	